



I-SPARK i-Size

USER GUIDE



MODEL: I-SPARK i-Size ECE R129.03 v.1.0

NOTE! Product graphics serve an illustrative function!

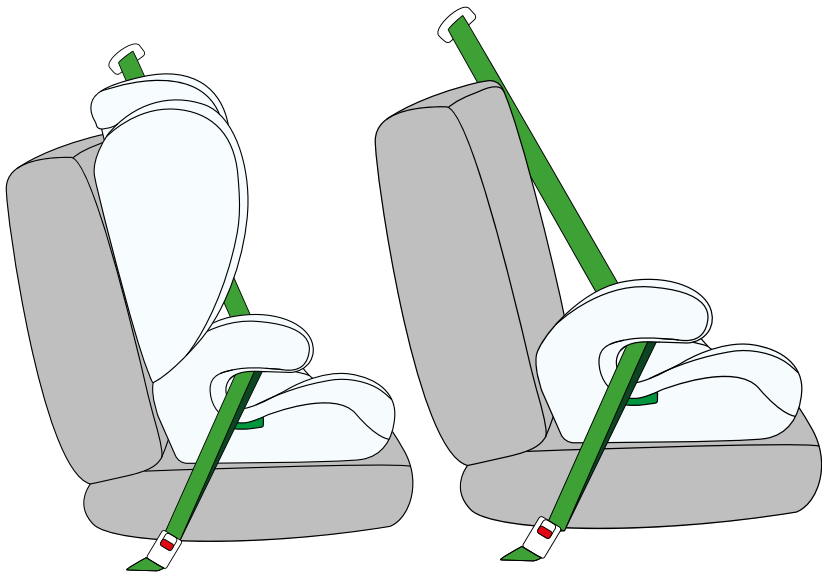

1.0 Usage

The car seat has been designed, tested and approved for use in accordance with the requirements of UN/ECE Regulation No. 129 concerning the approval of child restraint systems (UN/ECE R129/03).

The I-SPARK i-Size car seat is intended for transporting children 100-150 cm tall (up to approximately 12 years). The child should be fastened using three-point car seat belt for adults.

The car seat can be installed in the car in the places indicated by the manufacturer in the vehicle manual. It is required to read the vehicle manufacturer's operating instructions.

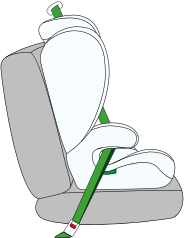
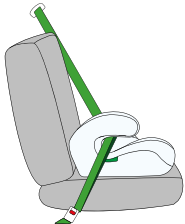
Hight of the child	Car seat setting	Car seat mounting
100-150cm		Three-point car seat belt
140-150cm		Three-point car seat belt



2.0 Safety instructions

Please take a few minutes to read this instruction manual in order to ensure the proper safety of your child.



- The car seat **MUST NOT** be installed on the vehicle seats mounted rearward facing or sideways.



- The car seat can only be installed on the vehicle seat with a three-point car seat belt.
- The front air-bag must be deactivated.



- It is recommended to install the car seat on the vehicle back seats only.

Please refer to your vehicle operating manual for information on the suitability of the vehicle seat for use with a car seat.

- Remember that the internal safety harness holding the child should be adapted to the child's body shape and not twisted. For this reason, the child should not wear thick clothes under the safety harness.
- The car seat waist belts must run as low as possible across your child's pelvis to ensure optimum effect in the event of an accident.
- The car seat should be replaced when it has been subjected to violent stresses during a traffic accident.
- The car seat may not be modified in any way without the acceptance of the relevant approval authority. Failure to install the car seat in accordance with the manufacturer's instructions may pose a threat to life and health of people.
- Protect the car seat from direct sunlight, otherwise your child may be burnt by heated parts. Protect your child and the car seat from sunlight.
- Never leave your child unattended in the car seat.

- Make sure that the luggage and other objects are adequately secured, in particular on the parcel shelf, as they can cause injuries in the event of a collision.
- The car seat cannot be used without the cover.
- Do not use replacement covers, other than those recommended by the manufacturer, as the cover is an integral part of the safety system of the car seat.
- Do not use any other attachment points than those described in the instruction manual and marked on the car seat.
- All hard elements and plastic parts of the child car seat should be placed and installed in a way that, under normal vehicle operating conditions, they cannot get trapped by the sliding seat or vehicle doors.
- Regularly check the technical condition of the car seat, pay special attention to the fixing points, seams and adjusting elements. It is important to ensure that all mechanical elements are fully operational. Never grease or oil parts of the car seat.
- Do not use the car seat if its parts are damaged or loose.

- In the event of an emergency, it is important to quickly unfasten the car seat belt. This means that the release button of the safety harness is not fully secured; make sure your child does not play with the safety harness.
- Set a good example for your child and wear your car seat belt at all times. An adult who is not fastened with a car seat belt can also pose a threat to a child.
- Make sure that the car seat is correctly secured before each journey in the car.
- The car seat must be secured at all times, even when not in use. The car seat that is not fastened can injure the passengers even during emergency braking.
- On some vehicle seats made of delicate materials, the use of car seats may leave marks and/or discolouration. To prevent this from happening, you can place a blanket, towel or similar product under the car seat.

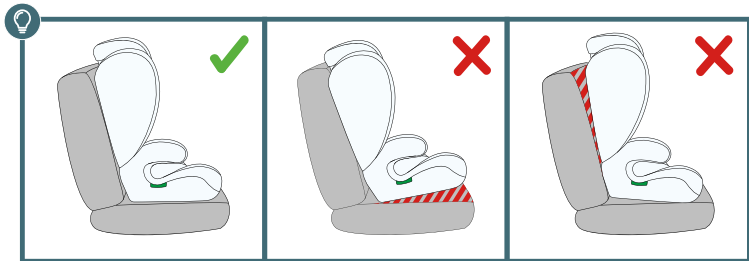

3.0 Securing the child and backrest adjustment"

The backrest of the car seat is movable, thanks to which it is possible to adjust it accurately to the plane of the vehicle seat. It is important for the car seat to be snug against the surface of the vehicle seat.



Tilt the backrest backwards until it is snug against the vehicle seat.



IMPORTANT! To ensure your child's comfort, move the front vehicle seat as far forward as possible to provide room for your child's legs.

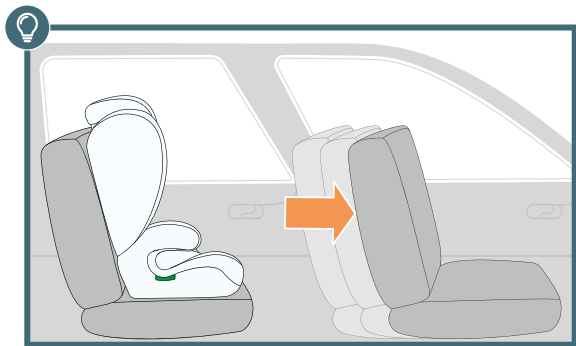

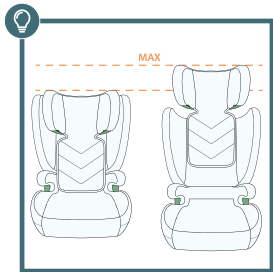
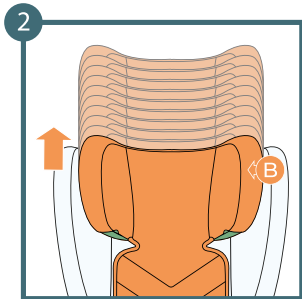
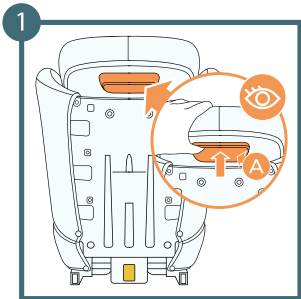

A: Headrest height adjustment lever
B: Headrest

3.1 Height of the headrest

The headrest should fit snugly around your child's head, with the lower part of the headrest at the same height as your child's shoulders.

1. Grasp the headrest adjustment lever located on the back of the headrest and pull it gently upwards
2. Adjust the headrest by selecting one of ten options and when the height is adjusted, release the adjustment lever.



IMPORTANT! Make sure the vehicle seat headrest is locked in place



The headrest should fit snugly around your child's head, with the lower part of the headrest at the same height as your child's shoulders.

3.2 Removing the car seat backrest

1. Uncover the inside of the car seat by unfastening the fasteners located on the backrest.
2. Push the backrest away from you so that the car sea backrest lies flat.
3. Detach the backrest by pulling it out of the latches.

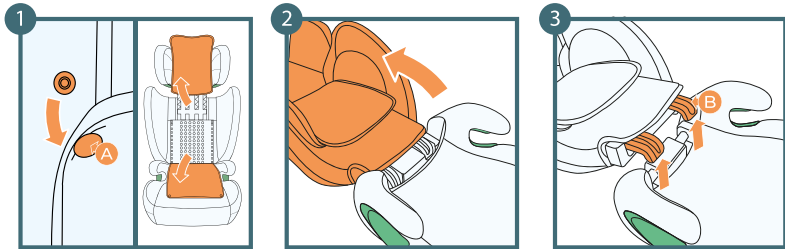

- A: Fastener**
B: Backrest latches

3.3 Installing the car seat backrest

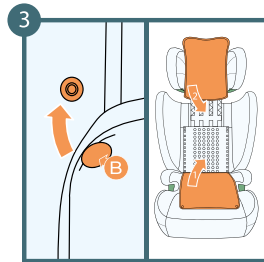
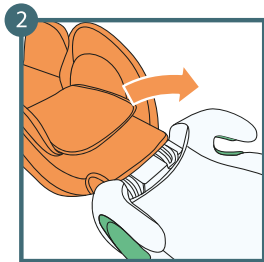
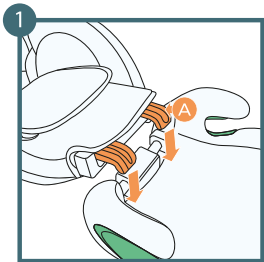

A: Backrest latches
B: Fasteners

1. Place the backrest flat behind the seat
2. Hook the lower part of the backrest onto the seat
3. Adjust the backrest until it locks in the vertical position. You will hear a characteristic "click" sound.



Note! When rotating the backrest, check whether there are no obstacles in the area of the connector between the backrest and the seat.

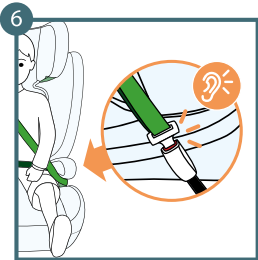
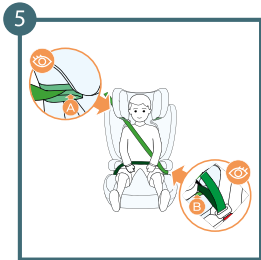
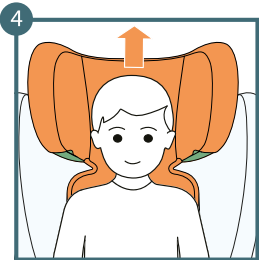
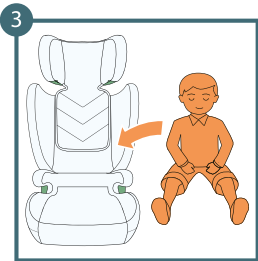
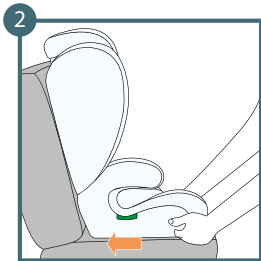
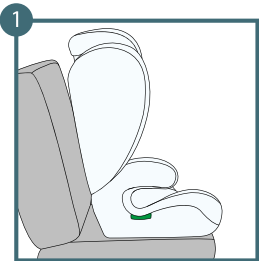

A: Shoulder belt guide
B: Waist belt guide

4.0 Installation of the car seat

Note! The car seat should be placed directly on the vehicle seat.

4.1 Children between 100 and 150 cm tall - using a three-point car seat belt.

1. Place the car seat on the vehicle seat.
2. Push the car seat all the way to the vehicle seat.
3. Place your child in the car seat
4. Adjust the headrest to the child's height
5. Guide the shoulder belt through the green shoulder belt guide and then through both waist belt guides.
6. Fasten the car seat belt. You will hear a characteristic "click".

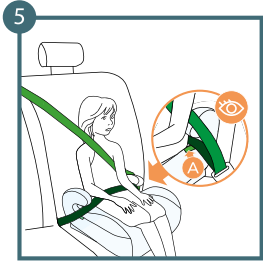
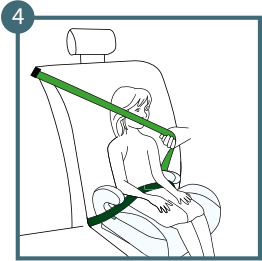
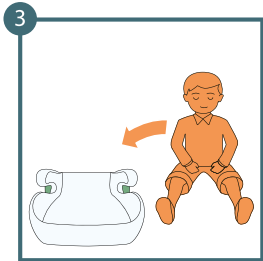
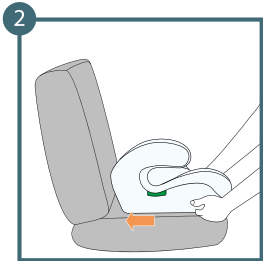
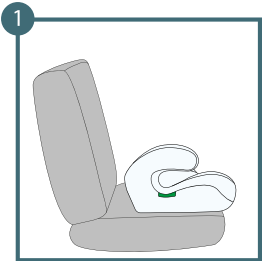

A: Waist belt guide

4.2 Children between 140 and 150 cm tall - using a three-point car seat belt.

1. Place the car seat on the vehicle seat.
2. Push the car seat all the way to the vehicle seat.
3. Place your child in the car seat
4. Pull the shoulder belt tight and guide it over your child's shoulder
5. Guide the car seat belt through both waist belt guides.
6. Fasten the car seat belt. You will hear a characteristic "click".

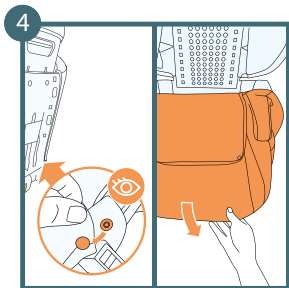
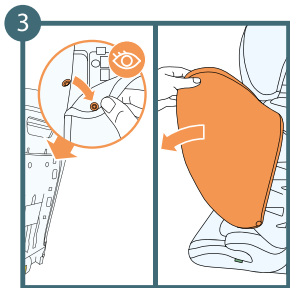
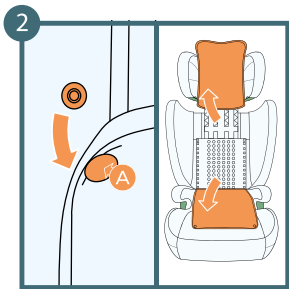
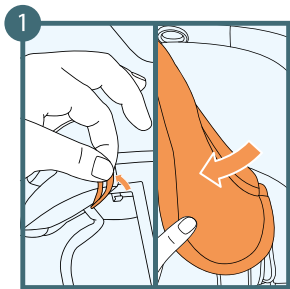

A: Fasteners

5.0 Removing the cover

1. Remove the fabric from the headrest starting from the sides. Gently stretch the elastic band securing the material and remove it from the hook.
2. Unfasten the fasteners located on both sides of the car seat backrest and then uncover the interior of the seat.
3. Unfasten the fasteners located on the sides of the car seat; slide the material off the sides of the car seat.
4. Unfasten the fasteners located at the back of the car seat (on its both sides), then pull the seat fabric towards you, sliding it off the car seat.

5.1 Installing the cover

To put the cover back on - just reverse the above sequence of actions. Align the cover with the attachment points on the car seat. Start by installing the cover on the shell of the car seat and finally on the headrest part.

6.0 Cleaning

NOTE! The car seat must not be used without the cover.

- The cover is removable and washable with a mild powder and using a program for delicate fabrics (30°C).
- Follow the washing instructions on the cover information label. The colours may fade if it is washed at the temperature above 30°C. The cover should not be centrifuged or dried in a tumble dryer (which may lead to separation of the material layers).
- Prolonged sun exposure of the cover is prohibited.
- Plastic parts can be cleaned with soap and water.
- Do not use aggressive cleaning agents (such as solvents).
- The safety harness can be cleaned in lukewarm soapy water.

Warning! You must not remove the metal clips from the safety harness.

The full text of the Warranty Terms and Conditions is available on the website WWW.KINDERKRAFT.COM



(AR) بضمان مصلحة عملائنا. نحن في خدمتكم! إذا كانت لديكم أي مشكلة مع المنتج الذي حصلتم عليه، فيجربى الاتصال بنا بالطريقة التي تفضلونها!

(CS) V zájmu péče o naše klienty - jsme rádi k dispozici! Pokud jste se setkali s nějakým problémem v souvislosti s obdržným výrobkem, kontaktujte nás způsobem, který vám nejvíce vyhovuje!

(DE) In Sorge für unsere Kunden - stehen wir gerne zu Ihrer Verfügung! Wenn Sie auf ein Problem mit dem erhaltenen Produkt treffen, treten Sie bitte mit uns in Kontakt in der bequemsten Weise für Sie!

(EN) In the interests of our Clients - we are at your disposal! If you have a problem with the product you received, contact us in the most convenient way for you!

(ES) ¡Por el bien de nuestros clientes, estamos a su disposición! ¡Si tiene cualquier problema con el producto recibido, póngase en contacto con nosotros de forma más cómoda para usted!

(FR) Dans l'intérêt de nos clients - nous sommes à votre disposition! Si vous avez un problème avec le produit que vous avez reçu, Contactez-nous de la manière la plus pratique pour vous!

(HU) Bármikor állunk az ügyfeleink rendelkezésére! Ha az átvett termékkel kapcsolatban valamilyen problémába ütközött, az Onnek legmegfelelőbb módon vegye fel velünk a kapcsolatot!

(IT) Prendersi cura dei nostri Clienti - siamo alla Vostra disposizione! Se hai incontrato un problema con il prodotto che hai ricevuto. Contattaci nel modo piu conveniente per te!

(NL) In het belang van onze klanten - staan wij ter beschikking! Als u een probleem met het ontvangen product tegenkomt, neemt contact met ons op via de manier die u het makkelijkste vindt!

(PL) W trosce o naszych Klientów - jesteśmy do dyspozycji! Jeśli napotkałeś problem dotyczący otrzymanego produktu, skontaktuj się z nami w najbardziej dogodny dla Ciebie sposób!

(PT) Para o conforto dos nossos Clientes - estamos sempre à sua disposição! Se tiver qualquer problema com o nosso produto, entre em contacto conosco de modo mais confortável para si!

(RO) In interesul clienților noștri - suntem la dispoziția dumneavoastră! Dacă aveți o problema cu produsul pe care l-ați primit, contactați-ne în modul cel mai convenabil pentru dvs.!

(RU) заботясь о наших клиентах, мы находимся в вашем распоряжении. Если вы столкнулись с проблемой, связанной с полученными продукто, свяжитесь с нами наиболее удобным для вас способом!

(SK) Náš zákazník je pre nás dôležitý - sme vám k dispozícii! Ak máte akýkoľvek problém súvisiaci s doručeným produktom, kontaktujte nás spôsobom, ktorý vám najviac vyhovuje!

(SV) I våra kundens intresse - vi står till ditt förfogande! Om du har problem med den produkt du fick, kontakta oss på det mest praktiska sättet för dig!

International contact:

support@kinderkraft.com

+44 20 4525 0748



kinderkraftofficial



kinderkraft



kinderkraftofficial

منتج/ VÝROBCE/HERSTELLER/MANUFACTURER/FABRICANTE/FABRICANT/
GYARTÓ/FABBRICANTE/FABRIKANT/PRODUCTENT/FABRICANTE/PRODUCĂTOR/
ПРОИЗВОДИТЕЛЬ/VÝROBCA/TILLVERKARE:

**4Kraft Sp. z o.o. ul. Tatrzańska 1/5
60-413 Poznań, Poland**