

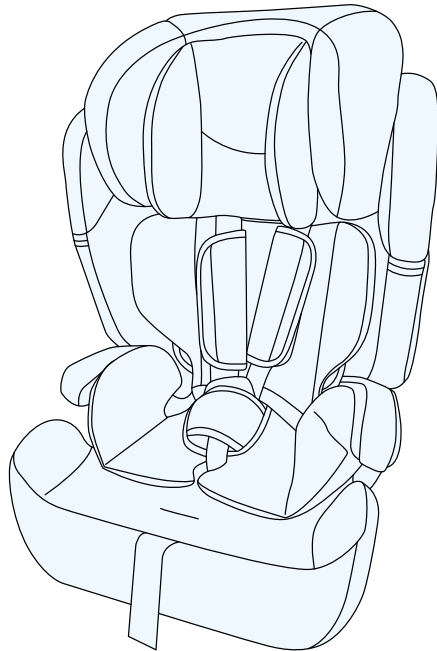

COMFORT UP i-Size USER GUIDE



MODEL: COMFORT UP i-Size ECE R129.03 v.1.0

ATTENTION! Product graphics serve an illustrative function.

A.1

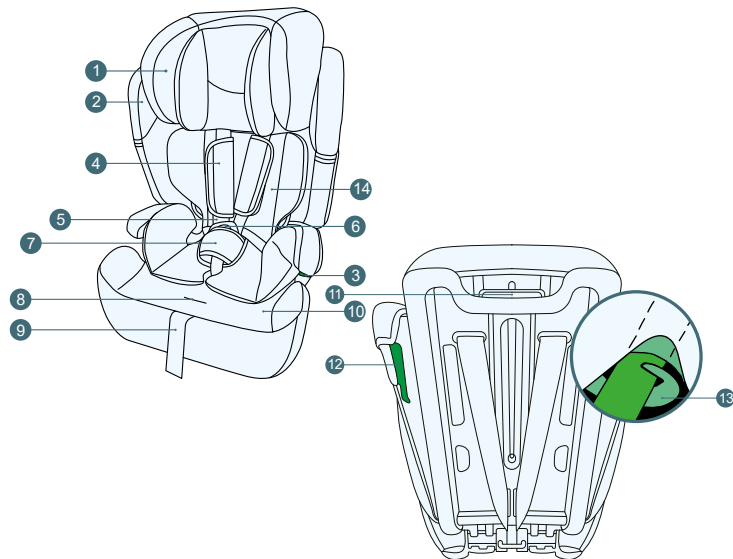

Please read the operating manual carefully before using the child car seat for the first time. Ensuring the safety of the child is your responsibility, and not reading this instruction may have an impact on it.

1.0 Car seat components

1. Headrest
2. Backrest
3. Waist safety harness guide
4. Removable internal safety harness pads
5. Internal safety harness
6. Internal safety harness buckle
7. Buckle pad
8. Button for adjusting the internal safety harness
9. Strap for adjusting the internal safety harness
10. Seat
11. Headrest height adjustment lever
12. Shoulder safety harness guide
13. Car seat belt latch
14. Internal car seat insert

Hight of the child	Car seat setting	Car seat mounting	Securing the child in a car seat
76cm - 105cm /≤18kg	forward facing	three-point car seat belt	Internal safety harness
100cm - 150cm	forward facing	three-point car seat belt	three-point car seat belt
		three-point car seat belt	three-point car seat belt

2.0 Usage

The car seat has been designed, tested and approved for use in accordance with the requirements of UN/ECE Regulation No. 129 concerning the approval of child improved restraint systems (UN/ECE R129/03).

The COMFORT UP i-Size car seat is designed for children from 76 cm to 150 cm in height and can be installed facing forward. In the range from 76 cm to 105 cm and up to 18 kg, the car seat is installed using a three-point seat belt. In this range, the child is held in the car seat by the inner safety harness. In the range from 100 cm to 150 cm, the car seat is installed using a three-point seat belt. In this range, the child is held in the car seat by a three-point car seat belt.

The car seat can be installed in the car in the places indicated by the manufacturer in the vehicle manual. It is required to read the vehicle manufacturer's operating instructions.

A.2

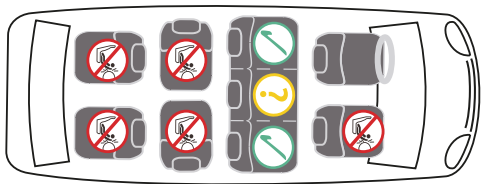

A.3

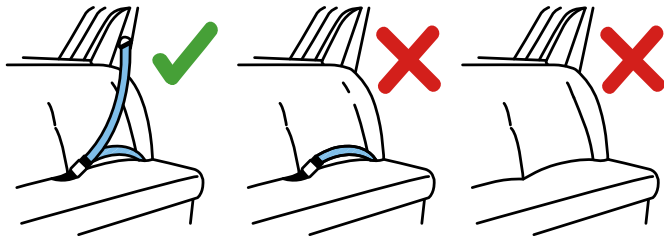

3.0 Safety instructions

WARNINGS

Please take a few minutes to read this instruction manual in order to ensure the proper security of your child. Many injuries that are easy to avoid are caused by reckless and improper use of the car seat.

- The car seat is designed to be mounted only on forward-facing seats. The car seat must not be mounted on rearward facing or side facing seats (fig. A.2).
- If the car seat is installed in the front seat, the front air-bag must be deactivated. It is recommended to install the car seat only on the back seats of the car. Please refer to your vehicle operating manual for information on the suitability of the seat for use with a car seat.
- Remember that the internal safety harness holding the child should be adapted to the child's body shape and not twisted. For this reason, child should not wear thick clothes under the safety harness.
- The car seat waist belts must run as low as possible across your child's pelvis to ensure optimum effect in the event of an accident.
- The car seat should be replaced when it has been subjected to violent stresses during a traffic accident.
- The car seat may not be modified in any way without the acceptance of the relevant approval authority. Failure to install the car seat in accordance with the manufacturer's instructions may pose a threat to life and health.
- Protect the car seat from direct sunlight, otherwise your child may be burnt by heated parts. Protect your child and car seat from sunlight.
- Never leave your child unattended in the car seat.
- Make sure that the luggage and other objects are adequately secured, in particular on the parcel shelf, as they can cause injuries in the event of a collision.
- The car seat cannot be used without the cover.

- Do not use replacement covers, other than those recommended by the manufacturer, as the cover is an integral part of the safety system of the car seat.
- Do not use any other attachment points than those described in the instruction manual and marked on the car seat.
- All hard elements and plastic parts of the child car seat should be placed and installed in a way that, under normal vehicle operating conditions, they cannot get trapped by the sliding seat or vehicle doors.
- Regularly check the technical condition of the car seat, pay special attention to the fixing points, seams and adjusting elements. It is important to ensure that all mechanical elements are fully operational. Never grease or oil parts of the car seat.
- Do not use the car seat if its parts are damaged or loose.
- In the event of an emergency, it is important to quickly unfasten the seat belt. This means that the release button of the safety harness is not fully secured; make sure your child does not play with the safety harness.
- Set a good example for your child and wear your car seat belt at all times. An adult who is not fastened with car seat belt can also pose a threat to a child.
- Make sure that the car seat is correctly fastened before each journey in the car.
- The car seat must be secured at all times, even when not in use. The car seat that is not fastened can injure the passengers even during emergency braking.
- On some vehicle seats made of delicate materials, the use of car seats may leave marks and/or discolouration. To prevent this from happening, you can place a blanket, towel or similar product under the car seat.

B.1

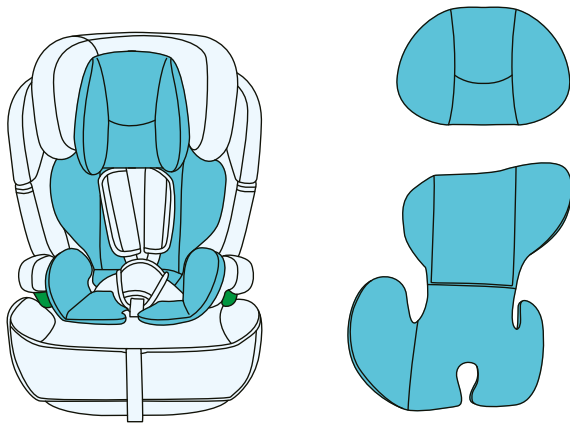

4.0 Use of insert

The baby insert (fig. B.1, item 15) improves comfort and gives extra support for young children. We recommend using the lower part as well as the upper part, which serves as a pillow for the child's head until the child needs more space in the car seat. Then the inserts should be removed.

4.1 Installation of insert

- Unfasten the internal safety harness (5) by pressing the red button on the buckle (6).
- Place the insert (14) in the car seat so that it adheres to the sides.
- Adjust the position of the internal safety harness. Check whether the safety harness is not twisted.
- Using a strap, place the upper part of the insert on the headrest.

C.1

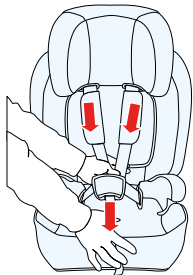

C.2

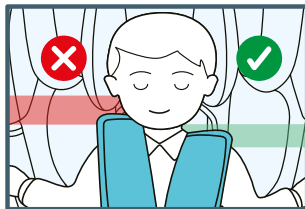

C.3

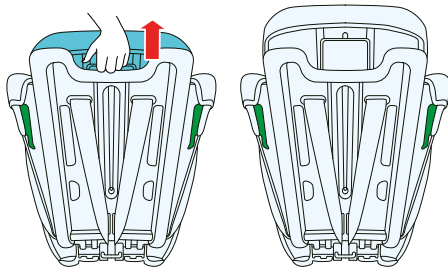

5.0 Using the car seat

5.1 Adjusting the position of the internal safety harness and the headrest

The adjustment of the car seat safety harness is integrated with the adjustment of the headrest. The headrest should be adjusted according to the child's height. The height of the safety harness will change with the height of the headrest. Before changing the position of the headrest, loosen the inner belts (5) by pressing the adjustment button (8) while pulling the shoulder straps towards you. (fig. C.1)

A correctly positioned headrest ensures optimal placement of the shoulder part of the vehicle seat belt and provides protection and comfort for your child. NOTE Adjust the appropriate height of the shoulder safety harness so that the harness enters the seat backrest slightly above the child's shoulders. (fig. C.2)

- To raise the headrest and shoulder safety harness, grasp the headrest adjustment lever (11) located on the back of the headrest (1) and pull it gently upwards. The headrest will be unlocked.
- The headrest (1) can now be adjusted to the desired height (fig. C.3). When the height is adjusted, let go of the adjustment lever (11) - the headrest will be locked after gently adjusting the height up and down.

IMPORTANT! Make sure the seat headrest is locked in place.

- In order to lower the headrest and shoulder safety harness, pull the headrest adjustment handle (11) and lower the headrest. The headrest and shoulder safety harness will be lowered at the same time.

C.4

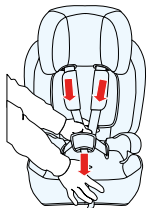

C.5

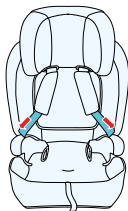

C.6



C.7

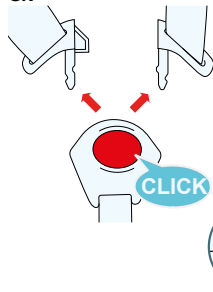

C.8



C.9

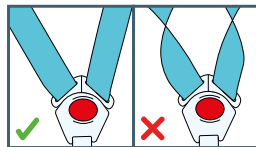

ATTENTION! Proper adjustment of the headrest height has a direct impact on the child's safety. Place the car seat on the vehicle seat. Place your child in the car seat and check the height of the headrest. Attention! If necessary, repeat the steps to adjust the headrest height until you reach the optimal height

5.2 Securing the child with the inner harness straps

- Loosen the internal safety harness fully by pressing the button (8) and pulling the safety harness straps (fig. C.4).
- Undo the buckle (6) and place the harness straps on the sides of the car seat (fig. B.5). Place the child in the car seat (fig. B.6).
- Adjust the headrest to the child's height (see section 5.1).
- Bring the two buckle latches together to engage them and insert them into the buckle (6) until you hear a "click" (fig. B.7).

5.3 Tightening the internal safety harness

- Pull the shoulder straps to eliminate slack in the waist section, so the internal safety harness will lie flat.
- Tighten the internal safety harness straps with the adjustment strap (8) until it lies flat on the child's body and close to it (fig. C.8).

NOTE The waist internal safety harness straps must be positioned as low as possible on the child's hips. Make sure that the harness straps are not twisted (fig. C.9).

D.1

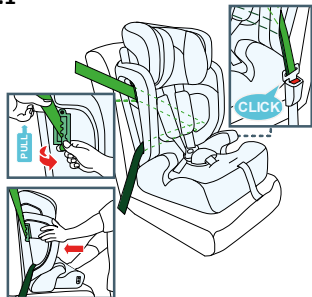

D.3

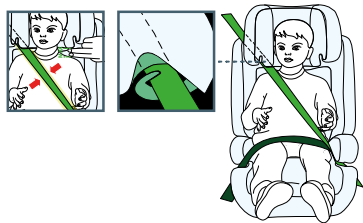

D.2

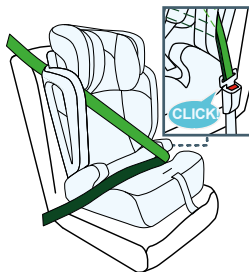

D.4

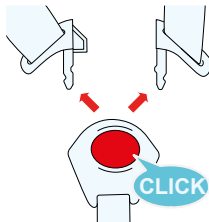

6.0 Installation in the car

In the event of sudden braking or an accident, people not wearing car seat belts may injure other passengers.

Always check whether:

- The seat backrests in the vehicle are locked (i.e. the folding backrest of the rear seat is latched).
- All heavy and sharp-edged items are secured (e.g. on the rear shelf).
- All passengers have fastened their seat belts.
- The car seat is always secured even if the child is not transported in it.



6.1 Forward-facing car seat installation for children between 76 and 105 cm tall using a three-point car seat belt

- Adjust the height of the shoulder straps and the headrest to the height of the child (see section 5.1).
- Place the car seat on the seat, making sure that the headrest of the seat does not interfere with the car seat's contact with the seat backrest.
- Pull out the car seat belt. Open the latch (13) for installation of the car seat belt. Pass the shoulder belt through the indicated latch (13) located on the side of the car seat. Pull the waist belt behind the fabric on the back of the seat. (fig. D.1)
- Pull the buckle together with the shoulder and waist belts behind the backrest to the other side of the car seat. (fig. D.2)
- Fasten the three-point car seat belt, you will hear a clicking sound (fig. D.4).

ATTENTION! Make sure that each part of the car seat belt is tight. Make sure all belts are in the correct positions and not twisted. Also check that the upholstery does not interfere with the movement of the belts.

- Proceed as described in section 5.2 and 5.3.

F.1

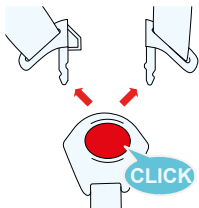

F.2

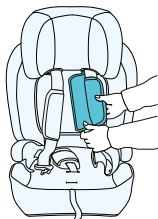

F.3

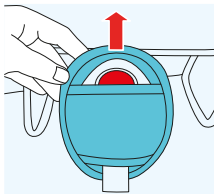

6.2 Forward-facing car seat installation for children between 100 and 150 cm tall using a car seat belt

6.2.1 Sowing away the internal safety harness

- Unfasten the buckle (fig. F.1)
- Remove the shoulder pads by unfastening their hook-and-loop fastener and the hook-and-loop fastener connecting them (fig. F.2)
- Remove the pad from the buckle and put the buckle through the opening in the cover (fig. F.3)
- Lift both pads from the backrest by unfastening the snap fasteners on the sides (fig. F.4)
- Place the buckle and straps in the slots on the seat (fig. F.5)
- Place the backrest pads in their original places, fasten the lower pad with the snap fasteners located on the sides. (fig. F.6)

F.4

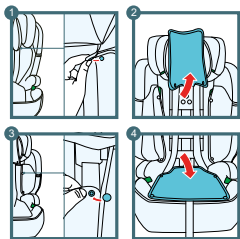

F.5

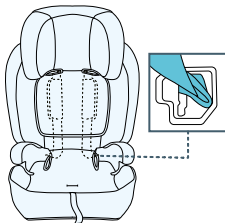

F.6

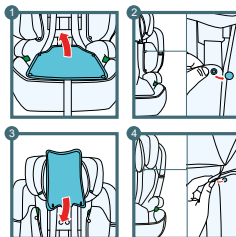

D.1

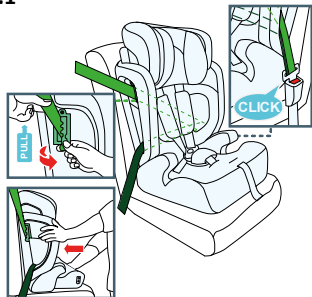

D.2

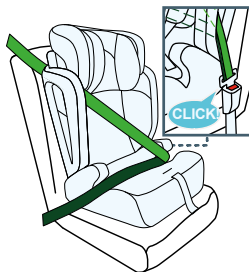

D.3

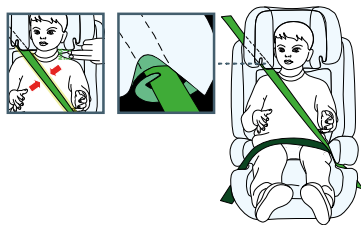

D.4

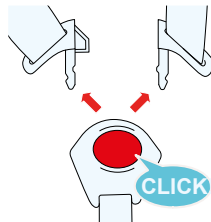

6.2.2 Car seat installation

Before installing the car seat, remove the safety harness of the car seat (see section 6.2.1).

Remember: The baby insert and protective pads should be stored in a safe place for future use.

- Adjust the headrest to the child's height (see section 5.1).
- Guide the shoulder belt through the green guide of the shoulder belt (2) (fig. D.1).
- Place the child in the car seat and guide the car belt under the armrests (belt line marked in green) of the waist belt (13) (fig. D.2).
- Fasten the vehicle seat belt, you will then hear a characteristic "click" (fig. D.3).
- Tighten the vehicle seat belt by pulling first on the waist safety harness section, then on the shoulder belt section (fig. D.4). Make sure that the waist belt is positioned as low as possible over your child's hips, fits into the guides and that it is fastened with a buckle. The shoulder belt should pass between the child's shoulder and neck. The belt cannot be twisted.

G.1

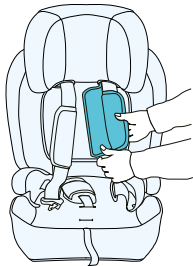

G.2

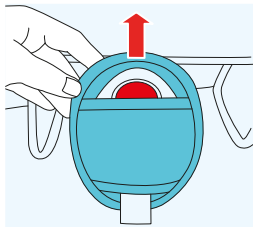

G.3

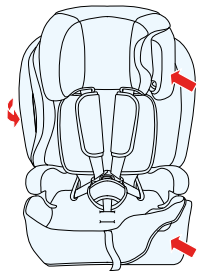

7.0 Maintenance instructions

7.1 Removing the cover

- Remove the insert if it is used (see section 4.1).
- Remove internal safety harness if used (see section 6.2.1)
- Remove the shoulder pads (fig. G.1)
- Remove the pad at the buckle of the internal safety harness. (fig. G.2)
- Remove the cover from the headrest of the car seat. (fig. G.3)
- Remove the cover from the edge of the car seat.

REMARK: For safety reasons, frequent removal is not recommended.

To install the cover, follow the above steps in reverse order.

8.0 Cleaning

All key parts of the car seat should be checked regularly. Mechanical parts should function flawlessly. Only the original cover should be used, as it is an essential element of the safety of the car seat.

ATTENTION! The car seat must not be used without the cover.

- Clean the cover only with neutral detergents and warm water. Do not wash in a washing machine; spinning and drying in a tumble dryer is not recommended. Pull out the foam that is placed inside the cover on the backrest of the car seat.
- Plastic parts can be cleaned with soap and water. Do not use aggressive cleaning agents (such as solvents).
- The internal safety harness can be cleaned in lukewarm soapy water. Warning! You must not remove the metal clips from the straps.



(AR) بضمان مصلحة عملائنا. نحن في خدمتكم! إذا كانت لديكم أي مشكلة مع المنتج الذي حصلتم عليه، فيجربى الاتصال بنا بالطريقة التي تفضلونها!

(CS) V zájmu péče o naše klienty - jsme rádi k dispozici! Pokud jste se setkali s nějakým problémem v souvislosti s obdrženým výrobkem, kontaktujte nás způsobem, který vám nejvíce vyhovuje!

(DE) In Sorge für unsere Kunden - stehen wir gerne zu Ihrer Verfügung! Wenn Sie auf ein Problem mit dem erhaltenen Produkt treffen, treten Sie bitte mit uns in Kontakt in der bequemsten Weise für Sie!

(EN) In the interests of our Clients - we are at your disposal! If you have a problem with the product you received, contact us in the most convenient way for you!

(ES) ¡Por el bien de nuestros clientes, estamos a su disposición! ¡Si tiene cualquier problema con el producto recibido, póngase en contacto con nosotros de forma más cómoda para usted!

(FR) Dans l'intérêt de nos clients - nous sommes à votre disposition! Si vous avez un problème avec le produit que vous avez reçu, contactez-nous de la manière la plus pratique pour vous!

(HU) Bármikor állunk az ügyfeleink rendelkezésére! Ha az átvett termékkel kapcsolatban valamilyen problémába ütközött, az Onnek legmegfelelőbb módon vegye fel velünk a kapcsolatot!

(IT) Prendersi cura dei nostri Clienti - siamo alla Vostra disposizione! Se hai incontrato un problema con il prodotto che hai ricevuto. Contattaci nel modo piu conveniente per te!

(NL) In het belang van onze klanten - staan wij ter beschikking! Als u een probleem met het ontvangen product tegenkomt, neemt contact met ons op via de manier die u het makkelijkste vindt!

(PL) W trosce o naszych Klientów - jesteśmy do dyspozycji! Jeśli napotkałeś problem dotyczący otrzymanego produktu, skontaktuj się z nami w najbardziej dogodny dla Ciebie sposób!

(PT) Para o conforto dos nossos Clientes - estamos sempre à sua disposição! Se tiver qualquer problema com o nosso produto, entre em contacto connosco de modo mais confortável para si!

(RO) In interesul clienților noștri - suntem la dispoziția dumneavoastră! Dacă aveți o problema cu produsul pe care l-ați primit, contactați-ne în modul cel mai convenabil pentru dvs.!

(RU) заботясь о наших клиентах, мы находимся в вашем распоряжении. Если вы столкнулись с проблемой, связанной с полученные продукто, свяжитесь с нами наиболее удобным для вас способ!

(SK) Náš zákazník je pre nás dôležitý - sme vám k dispozícii! Ak máte akýkoľvek problém súvisiaci s doručeným produktom, kontaktujte nás spôsobom, ktorý vám najviac vyhovuje!

(SV) I våra kundens intresse - vi står till ditt förfogande! Om du har problem med den produkt du fick, kontakta oss på det mest praktiska sättet för dig!

International contact:

support@kinderkraft.com

+44 20 4525 0748



kinderkraftofficial



kinderkraft



kinderkraftofficial

منتج/ VÝROBCE/HERSTELLER/MANUFACTURER/FABRICANTE/FABRICANT/
GYARTÓ/FABBRICANTE/FABRIKANT/PRODUCENT/FABRICANTE/PRODUCĂTOR/
ПРОИЗВОДИТЕЛЬ/VÝROBCA/TILLVERKARE:

**4Kraft Sp. z o.o. ul. Tatrzańska 1/5
60-413 Poznań, Poland**